

Seminar Room

Our lodge style room with open beams, plentiful windows and large field-stone fireplace creates an engaging environment ideal for encouraging productive meetings, training's and retreats.

Though easily accessible, the natural environment surrounding the building removes participants from the hustle and bustle of their normal day and allows them to focus on your goals.

Seminar Room Details:

- 3 connected rooms with movable walls, over 1600 square feet
- Seats 40 comfortably, theater style or at tables
- 18 tables with flexible arrangements; classroom, conference, or banquet
- WiFi included
- AV rental, white boards and easels with newsprint
- Parking for 30 cars
- Access to full kitchen with table settings, linens
- *\$800/day**

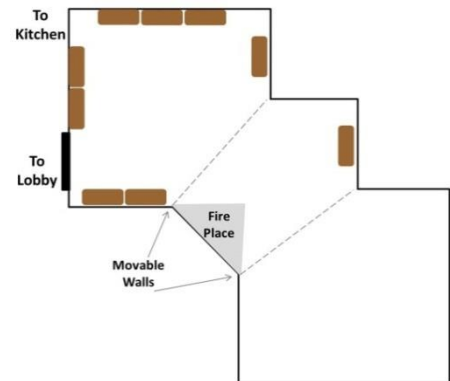
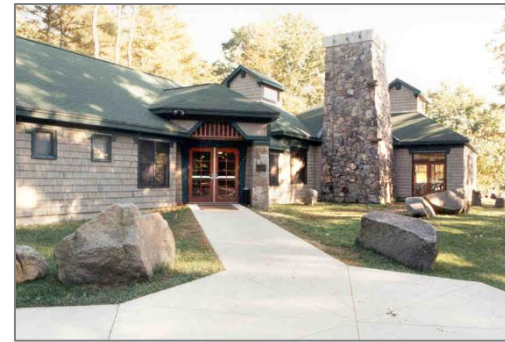

Yurts

Yurts are circular wooden shelters of Mongolian and Turkish origins. Both yurts have outdoor fire rings, picnic tables, and composting toilets. They **do not** have running water or electricity.

Corroboree

Our 30 foot diameter yurt ideal for gatherings, retreats and camping overnights. It can sleep 15 or seat 30 adults and is accessible by road when there is no snow. There is a propane heater to provide warmth on cold days. *\$150.00/day**

Nedoba

Our smaller yurt is 14 feet in diameter and an ideal place for personal and family retreats or as a base camp for group camping. It sleeps up to 3 adults and has space nearby to set up tents and tarps. *\$75.00/day**

